

WELCOME

Welcome to Ushaw, now open for all to enjoy. Marvel at wonderful Georgian and gothic Victorian architecture; enjoy our exciting and ever changing exhibits - experience the majesty of St Cuthbert's Chapel - and then relax with a walk in the formal gardens or Afternoon Tea in the Francis Thompson Room.

Ushaw opened as a College for training Priests in 1808 and carried on that role until 2011. Recently Ushaw started a programme of concerts and events and followed this by opening the nineteenth century chapels, reception rooms and gardens to the public every Saturday. Since then thousands of visitors have passed through our doors, expressing surprise that such an amazing place should have remained a secret for so long.

Our excellent café and well stocked shop are now also open - Afternoon Tea at Ushaw has become quite an attraction in itself.

Opportunities to book our wonderful rooms and spaces for conferences, meetings, tours, special dinners and celebration parties are also now available.

There's lots more information on our website www.ushaw.org.

This may be your first visit but we hope to see you again at the North East's newest heritage and visitor attraction.

MAKE THE MOST OF YOUR VISIT

Ushaw is open every Saturday until the end of October from 1.00pm -5.00pm.

GUIDED TOURS

Guided Tours are available for a small charge on Saturday afternoons, please purchase your ticket in the Gift Shop. Guided Tours are available for pre-booked groups at other times, please pick up a copy of our tours brochure.

GUIDE YOURSELF

Our tour guides will be happy to answer any questions if you would prefer to explore Ushaw at your own pace. The plan in this leaflet will help you get around.

THE FRANCIS THOMPSON ROOM

Why not spoil yourself with Afternoon Tea in the Francis Thompson Room, or perhaps just a quick coffee or cake - in the room which was once the Reading Room of the Main House.

USHAW GIFT SHOP

Don't forget to visit the Gift Shop which stocks a wide and growing range of both locally sourced products and cards & gifts exclusive to Ushaw.

USHAW

Free Guide



Discover USHAW



The Parlour designed by Edward Pugin, this was the formal dining room for the professors separate from the students.

The Refectory, designed by Augustus Pugin - this was the dining hall for students where dinners were eaten in silence.



The Exhibition Hall, originally the location of the first college Chapel and subsequently became a theatre for all manner of performances.

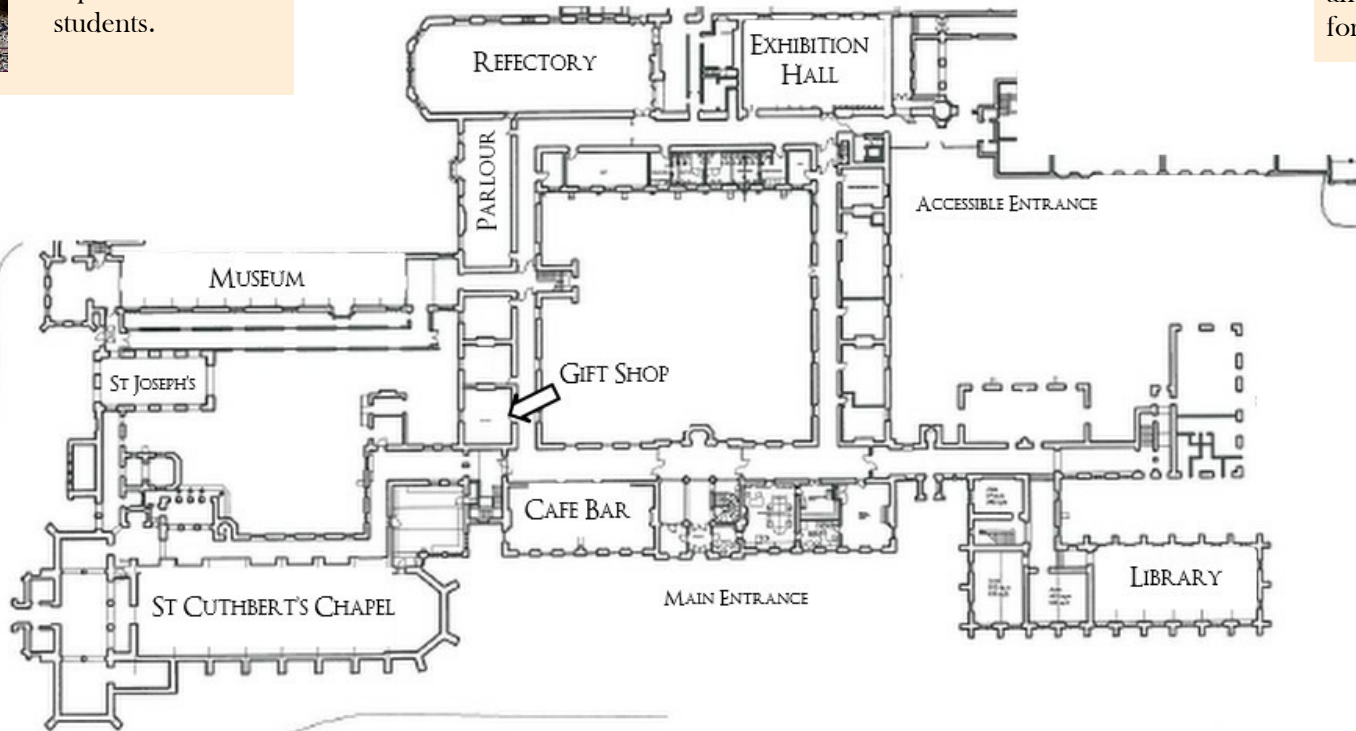

Ushaw College Library is home to the internationally significant archive and early printed book collections of the former Catholic seminary



St Cuthbert's Chapel, originally designed by Augustus Pugin in 1847 and then redesigned and rebuilt Dunn and Hansom in 1882.



The Main House designed by James Taylor of Islington. Construction started in 1804 -and opened in 1808. The top floor - know as "Tip Top" was added in 1906.

